

**FOR CONSTRUCTION**  
SUBMITTED DATE: 21 NOVEMBER 2014

DISTRIBUTION LIST

| NAME | שם | DATE | תאריך |
|------|----|------|-------|
|      |    |      |       |
|      |    |      |       |

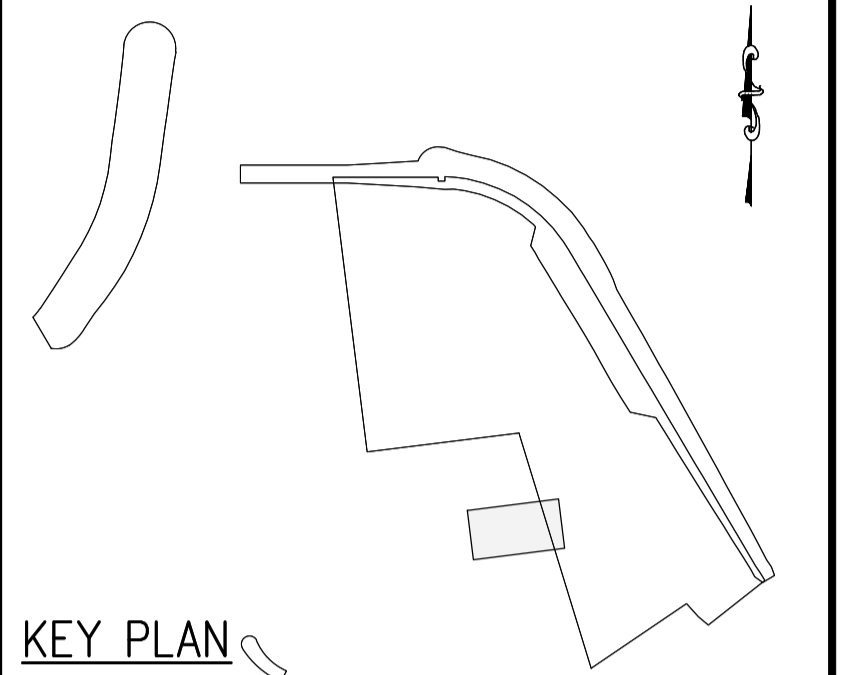

G.I.S. ENTITIES

| CODE | קוד | ENTITY | ישות | LOCATION ON DRAFT | מיקום בשרטוט |
|------|-----|--------|------|-------------------|--------------|
|      |     |        |      |                   |              |

REVISION

| חתימה | חתימה | שנה | חודש | יום | מס' חידוש |
|-------|-------|-----|------|-----|-----------|
|       |       |     |      |     |           |
|       |       |     |      |     |           |
|       |       |     |      |     |           |
|       |       |     |      |     |           |

|                               |  |   |                                  |
|-------------------------------|--|---|----------------------------------|
| <input type="checkbox"/> עיון | <input checked="" type="checkbox"/> מכתב | <input checked="" type="checkbox"/> ביצוע | <input type="checkbox"/> AS MADE |
| INFORMATION                   | TENDER                                   | CONSTRUCTION                              | AS MADE                          |
| DATE                          | DATE                                     | DATE                                      | DATE                             |
| תאריך                         | תאריך                                    | תאריך                                     | תאריך                            |
|                               | MARCH 2014                               | NOVEMBER 2014                             |                                  |

**חברת נמלי ישראל**  
 פיתוח ונכסים בע"מ  
 מנהלת המסופים העתידיים  
 ISRAEL PORTS  
 Development & Assets Company Ltd.  
 Terminals Development Division  
 NEW MARINE CONTAINER TERMINAL IN  
 HAIFA PORT (HAMIFRATZ PORT)

DRAWING NAME: **QUAYS AREA DEVELOPMENT PAVEMENT & DRAINAGE**

SUBJECT OF DRAWING: **PARTIAL PAVING PLAN SHEET 5 OF 17**

|          | שם            | תאריך      | חתימה |
|----------|---------------|------------|-------|
| DESIGNED | תכנן E.B.     | 21.07.2014 |       |
| DRAWN    | שרטט O.S.     | 21.07.2014 |       |
| CHECKED  | בקר G.G.      | 21.07.2014 |       |
| APPROVED | אושר ע"י B.P. | 31.03.14   |       |

SCALE: 1:500 DRAWING NO. 500-A3-P-0107-04C

FILE NAME + PATH: NHMCT111AC-500-A3-P-0107-04C.dwg

- XRefs:
- |                             |                             |
|-----------------------------|-----------------------------|
| HaifaKeyPlan.dwg            | B-NHMCT111AC-500-XW0001.dwg |
| G-NHMCT111AC-500-A3.dwg     | N-NHMCT111AC-500-XE0001.DWG |
| G-NHMCT111AC-500-XD0001.dwg | SURVEY_YULIUS2.DWG          |
| H-NHMCT111AC-500-XS0006.dwg | G-NHMCT111AC-500-XBW001.dwg |
| H-NHMCT111AC-500-XS0004.dwg | G-NHMCT111AC-500-XH0002.dwg |
| G-NHMCT111AC-500-XH01ch.dwg | G-NHMCT111AC-500-XDR003.dwg |
| G-NHMCT111AC-500-XD0002.dwg |                             |
| G-NHMCT111AC-500-XDR002.dwg |                             |
| A-NHMCT111AC-500-XCM001.dwg |                             |

CONSULTANTS: HPA ENGINEERS, P.C. and Graner D.L. Engineers Ltd.

- NOTES**
- ALL UNITS IN METERS UNLESS OTHERWISE NOTED.
  - ALL COORDINATES BASED ON THE "PROJECT COORDINATES". SEE DWG NO. A1-G-0061.
  - ALL ELEVATIONS BASED ON ISRAELI LAND SURVEY DATUM (ILSD).

**PARTIAL PLAN**  
SCALE 1:500

- LEGEND:**
- PAVED AREA
  - SUBBASE
  - GRAVEL

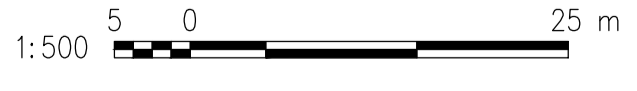

**GRAPHIC SCALES**  
CHECK BEFORE USE

IF SHEET IS LESS THAN 594mm X 841mm  
IT IS A REDUCED PRINT.  
SCALE ACCORDINGLY